

# Dome rooflight safety concept burglary prevention device and fall-through protection

**VELUX®**
**Commercial**

An ingenious package solution against burglary and for greater safety on the roof

## Safety level 1

SUPER-TOP/HAILSTOP/TOP-90 sound reduction  
Dome rooflights/pyramids with outer shell made of high-impact resistant polycarbonate and screw connection securing

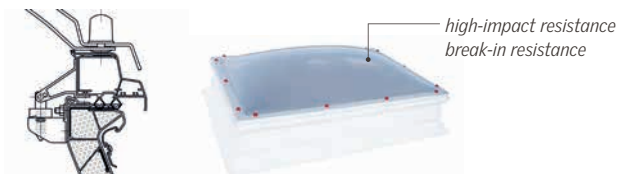

## Safety level 2

Steel grids installed in the clear opening (see cover picture)  
or type DSD fall-through protection system installed directly on the trapezoidal sheet

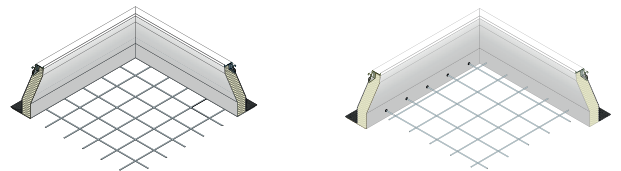

## Safety level 3

Steel tubes with large dimensioned cross bar installed in the clear opening

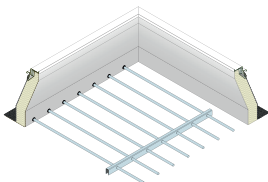

## Safety level 4

Roller grate security according VdS-guideline 2333 with reinforced cross bar as burglary resistant securing in compliance with resistance class 3 according to DIN V ENV 1625.

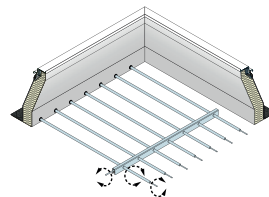

## Safety level 5

Level 1 to 4 with additional securing by REED flap contact against unnoticed opening and EM concussion detector for detection of impact load of any character. Starting from safety level 2, TOP-90 dome rooflights can be used as an alternative.

1.1.1  
TOP-90

1.1.2  
TOP-90 PLUS

1.1.3  
TOP-90  
sound reduction

1.2.1  
Dome rooflight upstands and  
roof connection systems

1.4.5  
LK-DDS

1.4.6  
LK-DDN

Applicable for the upstand types (cm)		Steel grid	Steel installation-tubes/ roller grate security				DSD	LK-DDN		LK-DDS ROUND
		Factory setting	Factory setting	Sub-structure	Retrofit kit	Sub-structure	Factory setting	Retrofit kit	Retrofit kit	
<b>Metal-AK</b>										
ISO-THERM AK upstand	30	-	-	•	•	•	-	•	-	
ISO-THERM AK upstand	40/50/60	•	•	•	•	•	-	•	-	
ISO-THERM AK upstand steep	30/40/50/60	•	•	•	•	•	-	•	-	
ISO-THERM AK upstand AS	40/50	•	•	•	•	•	-	•	-	
Metal AK upstand type TE	30	-	-	•	•	•	-	•	-	
Metal AK upstand type TE	40/50	•	•	•	•	•	-	•	-	
Metal RAK upstand	30	-	-	•	•	•	-	•	-	
Metal RAK upstand	40/50	•	•	•	•	•	-	•	-	
Aluminium TRP AK upstand	15/30	-	-	-	-	-	•	•	-	
Aluminium TRP AK upstand	30	-	-	-	-	-	•	•	-	
Aluminium thermal TRP AK upstand	15/30	-	-	-	-	-	•	•	-	
Aluminium thermal TRP RAK upstand	30	-	-	-	-	-	•	•	-	
Steel aluminium composite upstand	30	-	-	•	•	•	-	•	-	
Steel aluminium composite upstand with base flange	30	-	-	•	•	-	-	-	-	
Steel aluminium composite RAK upstand with base flange	30	-	-	•	•	-	-	-	-	
Steel aluminium composite AK upstand with TRP-side bend	30	-	-	•	•	-	-	•	-	
Steel aluminium composite AK upstand with hot flange preparation	40	•	•	•	•	•	-	•	-	
Steel aluminium composite RAK upstand	30	-	-	•	•	•	-	•	-	
Steel aluminium composite RAK upstand with TRP-side bend	30	-	-	•	•	-	-	•	-	
Steel aluminium composite RAK upstand with hot flange preparation	40	•	•	•	•	•	-	•	-	
Steel aluminium composite TRP-AK upstand	30	-	-	•	•	-	-	•	-	
Steel aluminium composite TRP-RAK upstand	30	-	-	•	•	-	-	•	-	
<b>PVC AK upstand</b>										
PVC AK upstand	15/30/45	-	-	•	-	•	-	•	-	
<b>GRP-AK</b>										
GRP AK upstand	15/30/50	-	-	•	-	•	-	•	-	
GRP RAK upstand	30/45	-	-	•	-	•	-	•	-	
GRP upstand AK corrugated profile	20/30	-	-	•	-	-	-	•	-	
GRP upstand RAK corrugated profile	30	-	-	•	-	-	-	•	-	
GRP TRP RAK upstand	30	-	-	•	-	-	-	•	-	
GRP AK upstand with TRP-side bend	15/30/50	-	-	•	-	-	-	•	-	
GRP RAK upstand with TRP-side bend	30	-	-	•	-	-	-	•	-	
GRP aluminium composite TRP AK upstand	15/30/50	-	-	•	-	-	-	•	-	
GRP aluminium composite TRP RAK upstand	30	-	-	•	-	-	-	•	-	
GRP AK upstand with base flange	15/30/50	-	-	•	-	-	-	•	-	
GRP RAK upstand with base flange	30	-	-	•	-	-	-	•	-	
GRP AK upstand with hot flange preparation	30/50	-	-	•	-	-	-	•	-	
GRP RAK upstand with hot flange preparation	30/45	-	-	•	-	-	-	•	-	
GRP AK upstand round	15/30/50	-	-	-	-	-	-	-	•	
<b>Rehabilitation AK upstand</b>										
PVC extension unit	15/30	-	-	-	-	-	-	•	-	
Metal riser	25	•	•	-	•	-	-	•	-	
<b>External AK upstand</b>										
External AK upstand		-	-	-	-	-	-	•	•	

• = available  
- = not applicable

**Note:** All fall-through protection products are also suitable for installation in dome rooflights with SHEV function. Technical clarification is required before installation.